

SOCIAL RETREAT PACKAGES

# guest room layouts

## first floor diagram

LAKE-VIEW ROOMS

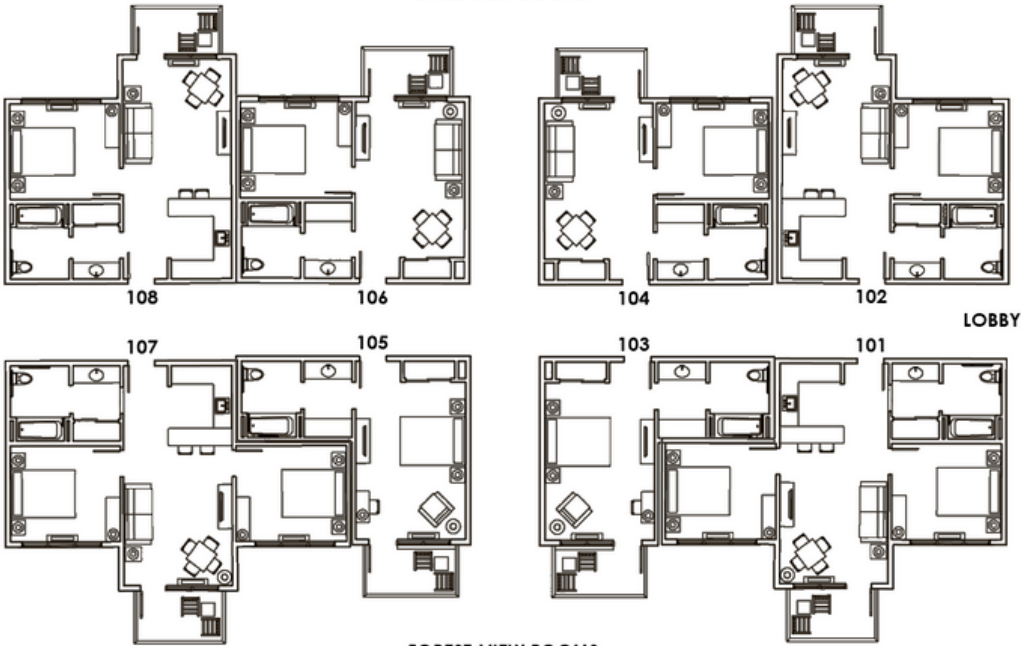

FOREST-VIEW ROOMS

## second floor diagram

LAKE-VIEW ROOMS

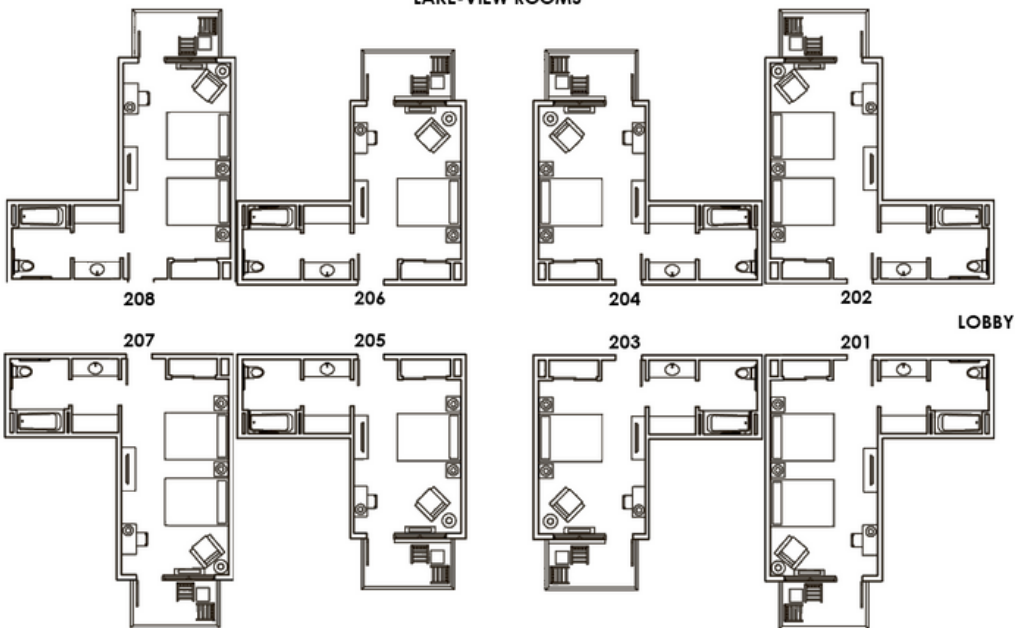

FOREST-VIEW ROOMS

### Coordinator Notes:

All guest rooms feature a mini fridge, microwave and coffee pot. Small and Large Suites offer kitchenettes with a small toaster oven, counter space with seating and fully stocked cupboards

Every guest room features a walk out balcony or patio area

Although our entire facility is ADA accessible, the private bedrooms in the suite style rooms have a more narrow space alongside the beds, which can create difficulties for guests in wheelchairs to access the bed

Every room has a hairdryer, iron and ironing board

Need to add an extra guest in a room over the occupancy noted on the "Rooming Assignments" page? The inn has memory foam rollaway beds for an additional \$15 per night, cribs and pack n plays for the little ones at no additional charge or your guests can bring their own air mattress!

Check in is after 3pm and check out is before 11am